

LOW VOLTAGE TRANSFORMER INSTALLATION GUIDE

THIS INSTRUCTIONS APPLY TO MODEL:

TR-75W-MT-T-SS

SAFETY:

This fixture must be installed in accordance with the National Electric Code and local code specifications. Failure to follow these codes and installation instructions will void the warranty and may result in serious injury and/or damage to the fixture. This product is designed for above ground installation only. Keep these instructions for future use.

- **WARNING!** Risk of fire or electrical shock. Install the transformer at least 5 feet (1.5m) from pool or spa and at least 10 feet (3.05m) from a fountain.
- This transformer must be connected to GFCI receptacle. If the receptacle is outdoors then it must be protected by an in-used weather-proof cover.
- All transformers are indoor and outdoor rated, but we recommend the transformer be mounted outdoors. If mounted indoors, then codes should be followed that apply to indoor wiring - especially for wires that pass through exterior walls.
- Transformer must be mounted in a vertical orientation with the bottom plate at least 1 feet from ground.
- It is normal for the unit to become hot, do not allow contact with PVC or plastic sidings. In hot climates, avoid mounting in direct sunlight, but allow photocell to be exposed to sky. Near salt-water, protect unit by enclosing in weather-proof structure.

FEATURES AND CONTROLS:

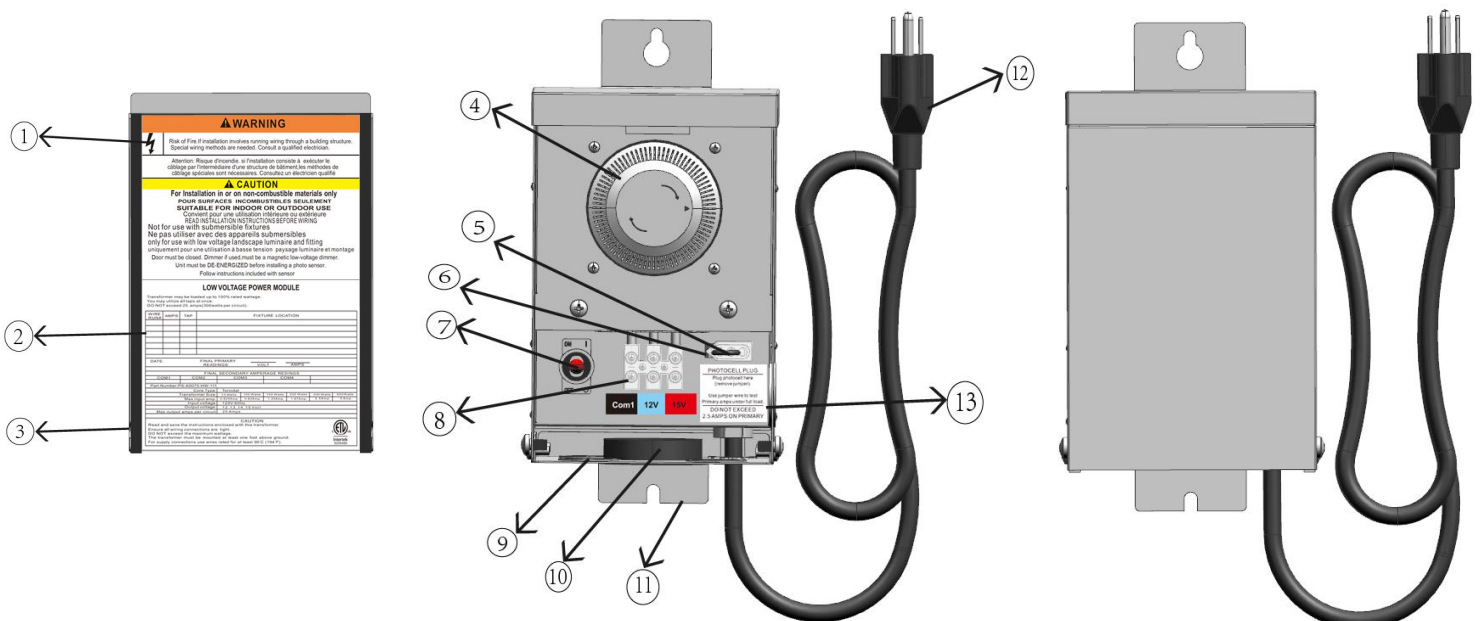

LOW VOLTAGE TRANSFORMER INSTALLATION GUIDE

- ① - Warning Label
- ② - Operating Record
- ③ - Locking Hole
- ④ - Mechanical Timer
- ⑤ - Testing Loop
- ⑥ - Photocell Plug
- ⑦ - Overload Circuit Breaker
- ⑧ - Terminal Block
- ⑨ - Knockout
- ⑩ - Conduit Cover
- ⑪ - Mounting Tab
- ⑫ - Power Cord
- ⑬ - Photocell Knockout

MOUNTING TRANSFORMER:

Mount transformer to solid surface or stand using stainless steel screws and anchors (if needed) (hardware not included). Screws will pass through keyholes. Use bubble level to ensure vertical mounting. Bottom of transformer must be at least 1 feet above ground.

TRANSFORMER SIZING:

The total lamp VA (load) of all fixture connected to one transformer must not exceed 70% of the VA capacity of the transformer. Therefore, the transformer selections is primarily based on Total Fixture Load:

$$\text{Total Fixture Load (Watts or VA)} \div 0.7 = \text{Min. Transformer Capacity}$$

Example: Total fixture load is 200 watts, divide by 0.7 to equal 286 watts, a 300W transformer would be ideal.

SELECT YOUR WIRE:

We recommend using 12 AWG low voltage direct landscape wire. It is important to distribute fixtures evenly along the cable with higher wattage fixtures closer to the transformer it possible. Only use the bottom terminals for wiring to lighting. Do not loosen the top terminals. They are for internal wiring of the transformer.

The higher voltage terminals are for long wire runs to lights. These will help account for voltage loss along the long run of wire.

LOW VOLTAGE TRANSFORMER INSTALLATION GUIDE

Voltage Loss Calculation:

$$\left(\frac{\text{Distance (Ft.)}}{\text{Cable Constant}} \times \frac{\text{Load (W)}}{\text{Cable Constant}} \times 2 \right) \div \frac{\text{Cable Constant}}{\text{Voltage Loss}} = \frac{\text{Voltage Loss}}{\text{Cable Constant}}$$

Wire Gauge	Cable Constant	Wire Gauge	Cable Constant
#18/2	1380	#12/2	7500
#16/2	2200	#10/2	11920
#14/2	3500		

SELECT VOLTAGE TAPS:

Transformer are Multi-Tap - giving you a selection of voltages for your wire run connections. Selecting a higher voltage at the transformer compensates for voltage that may be lost along wire runs.

Notes: Do not over-twist the wires, make sure the twisted wires are flat and can fit evenly into the terminal block.

INSTALLING A PHOTOCELL:

- Unplug the transformer from the outlet, open the enclosure.
- Remove a knockout from the side of enclosure, and install the photocell.
- Remove the jumper, plug the photocell into the socket.
- Position the photocell so that the operation is not effected time by any light fixture.



LOW VOLTAGE TRANSFORMER INSTALLATION GUIDE

OPERATING 75WATT TIMER:

- CLOCKWISE rotate the outer portion of timer until the arrow on the right-sides, points to the current time (24 hours).
- Slide the dark gray tabs(15 minutes per tab) towards the center to allotted you want the lights to be on.

CHECK THE SYSTEM:

After the installation is completed, to verify the circuit, first switch the breaker to the "ON" position, and then operate the system for five minutes. On the low voltage side, all electrical connections spots should be cool to touch. If a connection is hot to the touch, re-tighten the connection and check to ensure that the temperature decreases.

Place the transformer cover back and tighten all four provide screws on both sides.

Product Dimension

